

## PDF technical sheet 24138EAW33C3



### Double row spherical roller bearings

Spherical roller bearing, with central rib on inner ring, pressed steel cage, groove and lubrication holes on outer ring

Product definition	
d	7.4803 "
D	12.5984 "
B	5.0394 "
d2	8.4016 "
D1	10.9409 "
rs min	0.1181 "
Number of lubrication holes	3
b	0.5591 "
k	0.2362 "
e	0.38
Y1	1.76
Y2	2.62
Y0	1.72
Radial clearance class	C3
Mass	148.50 oz
Brand	SNR

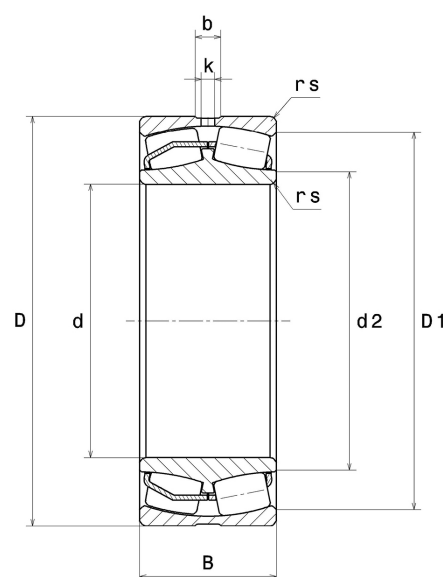

Product performance	
Dynamic load, C	1,850 kN
Static load, C0	2,480 kN
Fatigue limit load, Cu	141 kN
Nref	1,100 RPM
Nlim	1,600 RPM
Min operating temperature, Tmin	-40 °C
Max operating temperature, Tmax	392 °C
Characteristic cage frequency, FTF	0.43 Hz
Characteristic rolling element frequency, BSF	6.98 Hz
Characteristic outer ring frequency, BPF0	8.64 Hz
Characteristic inner ring frequency, BPF1	11.36 Hz

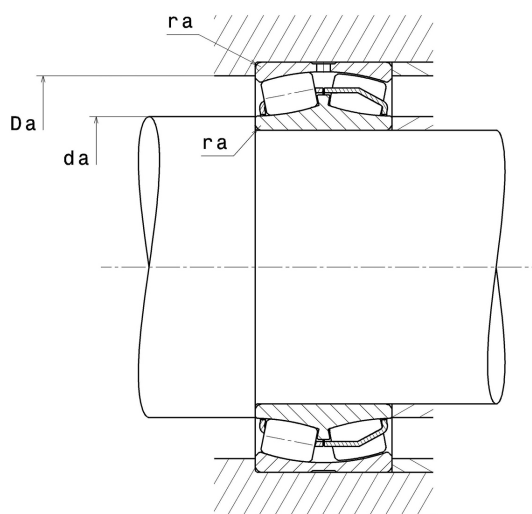

### Abutment dimensions

da min	8.0315 "
Da max	12.0472 "
ra max	0.0984 "

### Calculation factors

#### Equivalent dynamic radial load

$$P = X.F_r + Y.F_a$$

Fa / Fr ≤ e		Fa / Fr > e	
X	Y	X	Y
1	Y1	0.67	Y2

#### Equivalent static radial load

$$P_0 = X_0.F_r + Y_0.F_a$$

X <sub>0</sub>	Y <sub>0</sub>
1	Y0

The values for e, Y1, Y2 and Y0 are shown in the above table .