

## PDF technical sheet 24134EAW33C3



### Double row spherical roller bearings

Spherical roller bearing, with central rib on inner ring, pressed steel cage, groove and lubrication holes on outer ring

Product definition	
d	6.6929 "
D	11.0236 "
B	4.2913 "
d2	7.4606 "
D1	9.5906 "
rs min	0.0827 "
Number of lubrication holes	3
b	0.5197 "
k	0.2362 "
e	0.37
Y1	1.83
Y2	2.72
Y0	1.79
Radial clearance class	C3
Mass	93.83 oz
Brand	SNR

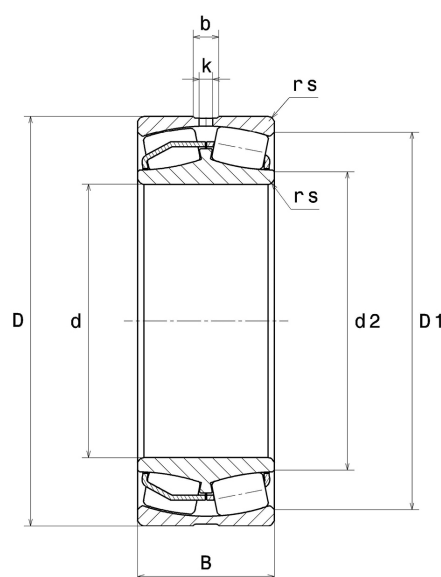

Product performance	
Dynamic load, C	1,370 kN
Static load, C0	1,840 kN
Fatigue limit load, Cu	111 kN
Nref	1,300 RPM
Nlim	1,800 RPM
Min operating temperature, Tmin	-40 °C
Max operating temperature, Tmax	392 °C
Characteristic cage frequency, FTF	0.44 Hz
Characteristic rolling element frequency, BSF	7.36 Hz
Characteristic outer ring frequency, BPF0	9.14 Hz
Characteristic inner ring frequency, BPF1	11.86 Hz

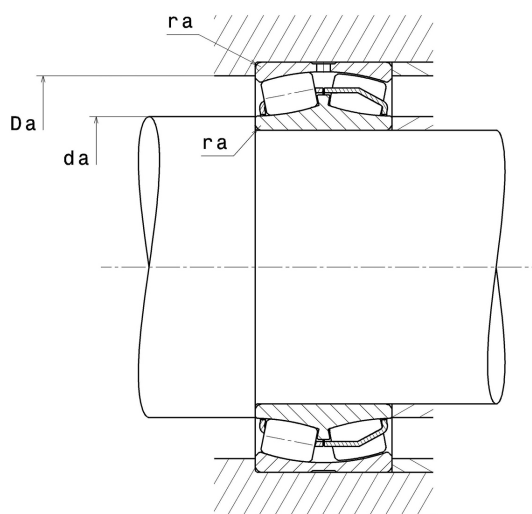

### Abutment dimensions

da min	7.1654 "
Da max	10.5512 "
ra max	0.0787 "

### Calculation factors

#### Equivalent dynamic radial load

$$P = X.F_r + Y.F_a$$

Fa / Fr ≤ e		Fa / Fr > e	
X	Y	X	Y
1	Y1	0.67	Y2

#### Equivalent static radial load

$$P_0 = X_0.F_r + Y_0.F_a$$

X <sub>0</sub>	Y <sub>0</sub>
1	Y0

The values for e, Y1, Y2 and Y0 are shown in the above table .