

PDF technical sheet 24044EMW33



Double row spherical roller bearings

Spherical roller bearing, one-piece machined cage, groove and lubrication holes on outer ring

Product definition	
d	8.6614 "
D	13.3858 "
B	4.6457 "
D1	11.9449 "
rs min	0.1181 "
Number of lubrication holes	3
b	0.5551 "
k	0.2362 "
e	0.31
Y1	2.18
Y2	3.25
Y0	2.13
Radial clearance class	CN
Mass	135.45 oz
Brand	SNR

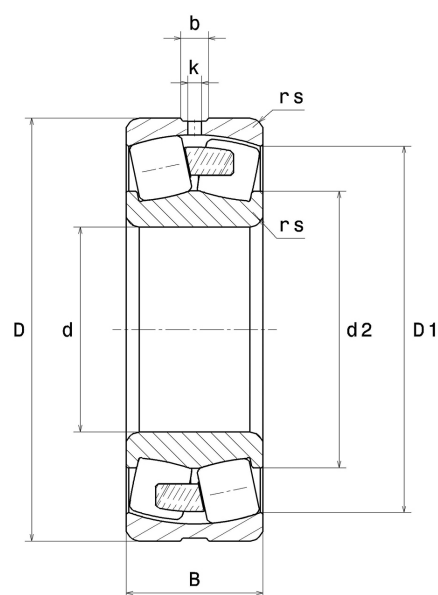

Product performance	
Dynamic load, C	1,930 kN
Static load, C0	2,750 kN
Fatigue limit load, Cu	161 kN
Nref	1,200 RPM
Nlim	1,800 RPM
Min operating temperature, Tmin	-40 °C
Max operating temperature, Tmax	392 °C
Characteristic cage frequency, FTF	0.44 Hz
Characteristic rolling element frequency, BSF	7.94 Hz
Characteristic outer ring frequency, BPF0	10.10 Hz
Characteristic inner ring frequency, BPF1	12.90 Hz

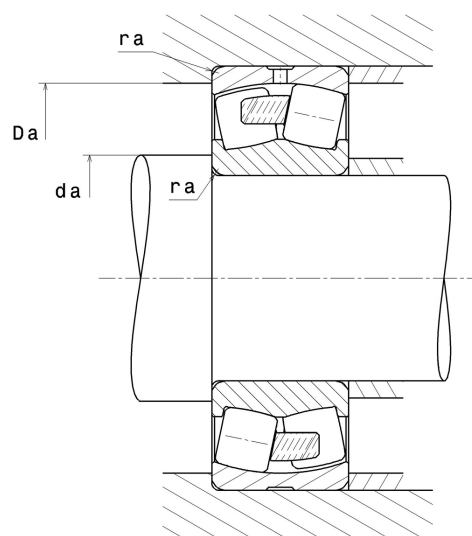

Abutment dimensions

da min	9.1496 "
Da max	12.8976 "
ra max	0.0984 "

Calculation factors

Equivalent dynamic radial load

$$P = X.F_r + Y.F_a$$

Fa / Fr ≤ e		Fa / Fr > e	
X	Y	X	Y
1	Y1	0.67	Y2

Equivalent static radial load

$$P_0 = X_0.F_r + Y_0.F_a$$

X ₀	Y ₀
1	Y0

The values for e, Y1, Y2 and Y0 are shown in the above table .