

## PDF technical sheet 23220EAW33C3



### Double row spherical roller bearings

Spherical roller bearing, pressed steel cage, groove and lubrication holes on outer ring

Product definition	
d	3.9370 "
D	7.0866 "
B	2.3740 "
d2	4.6535 "
D1	6.2559 "
rs min	0.0827 "
Number of lubrication holes	3
b	0.3701 "
k	0.1772 "
e	0.31
Y1	2.18
Y2	3.24
Y0	2.13
Radial clearance class	C3
Mass	22.58 oz
Brand	SNR



Product performance	
Dynamic load, C	586 kN
Static load, C0	661 kN
Fatigue limit load, Cu	52.70 kN
Nref	2,600 RPM
Nlim	3,300 RPM
Min operating temperature, Tmin	-40 °C
Max operating temperature, Tmax	392 °C
Characteristic cage frequency, FTF	0.43 Hz
Characteristic rolling element frequency, BSF	6.34 Hz
Characteristic outer ring frequency, BPF0	7.64 Hz
Characteristic inner ring frequency, BPF1	10.36 Hz

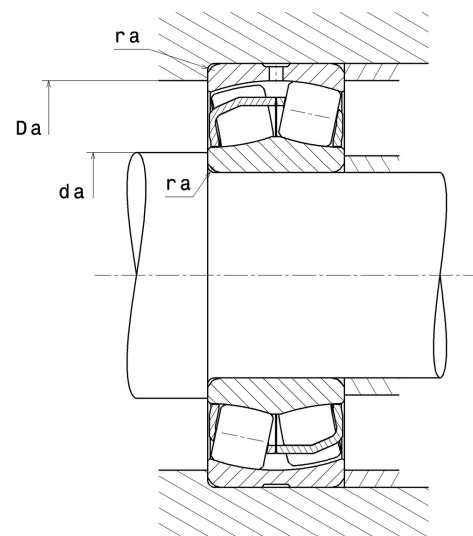

### Abutment dimensions

da min	4.4094 "
Da max	6.6142 "
ra max	0.0787 "

### Calculation factors

#### Equivalent dynamic radial load

$$P = X.F_r + Y.F_a$$

Fa / Fr ≤ e		Fa / Fr > e	
X	Y	X	Y
1	Y1	0.67	Y2

#### Equivalent static radial load

$$P_0 = X_0.F_r + Y_0.F_a$$

X <sub>0</sub>	Y <sub>0</sub>
1	Y0

The values for e, Y1, Y2 and Y0 are shown in the above table .