

## PDF technical sheet 23040EMW33



### Double row spherical roller bearings

Spherical roller bearing, one-piece machined cage, groove and lubrication holes on outer ring

Product definition	
d	7.8740 "
D	12.2047 "
B	3.2283 "
D1	11.1142 "
rs min	0.0827 "
Number of lubrication holes	3
b	0.5630 "
k	0.2756 "
e	0.23
Y1	2.95
Y2	4.4
Y0	2.89
Radial clearance class	CN
Mass	85.01 oz
Brand	SNR

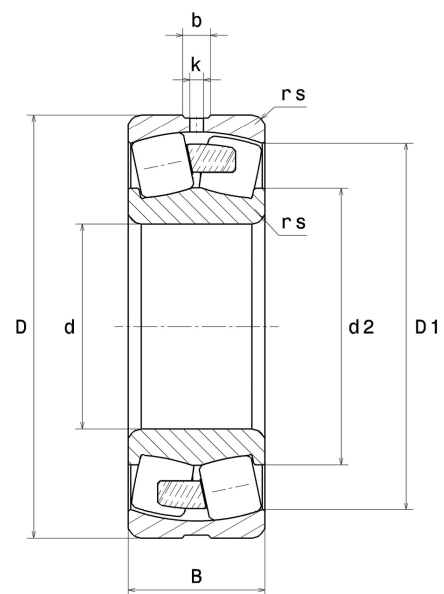

Product performance	
Dynamic load, C	1,310 kN
Static load, C0	1,790 kN
Fatigue limit load, Cu	135 kN
Nref	1,800 RPM
Nlim	2,300 RPM
Min operating temperature, Tmin	-40 °C
Max operating temperature, Tmax	392 °C
Characteristic cage frequency, FTF	0.44 Hz
Characteristic rolling element frequency, BSF	8.37 Hz
Characteristic outer ring frequency, BPF0	10.60 Hz
Characteristic inner ring frequency, BPF1	13.40 Hz

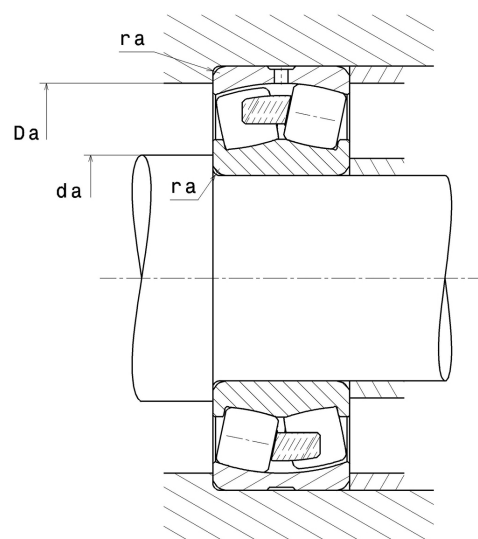

### Abutment dimensions

da min	8.2756 "
Da max	11.8031 "
ra max	0.0787 "

### Calculation factors

#### Equivalent dynamic radial load

$$P = X.F_r + Y.F_a$$

Fa / Fr ≤ e		Fa / Fr > e	
X	Y	X	Y
1	Y1	0.67	Y2

#### Equivalent static radial load

$$P_0 = X_0.F_r + Y_0.F_a$$

X <sub>0</sub>	Y <sub>0</sub>
1	Y0

The values for e, Y1, Y2 and Y0 are shown in the above table .