

## PDF technical sheet 22338EMW33



### Double row spherical roller bearings

Spherical roller bearing, one-piece machined cage, groove and lubrication holes on outer ring

Product definition	
d	7.4803 "
D	15.7480 "
B	5.1969 "
d2	10.3228 "
D1	13.6063 "
rs min	0.1969 "
Number of lubrication holes	3
b	0.8189 "
k	0.3937 "
e	0.32
Y1	2.12
Y2	3.15
Y0	2.07
Radial clearance class	CN
Mass	287.84 oz
Brand	SNR

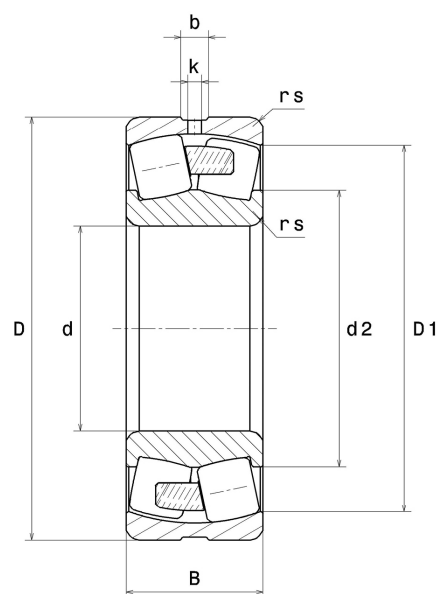

Product performance	
Dynamic load, C	2,600 kN
Static load, C0	3,120 kN
Fatigue limit load, Cu	209 kN
Nref	1,100 RPM
Nlim	1,600 RPM
Min operating temperature, Tmin	-40 °C
Max operating temperature, Tmax	392 °C
Characteristic cage frequency, FTF	0.42 Hz
Characteristic rolling element frequency, BSF	5.62 Hz
Characteristic outer ring frequency, BPF0	7.06 Hz
Characteristic inner ring frequency, BPF1	9.94 Hz

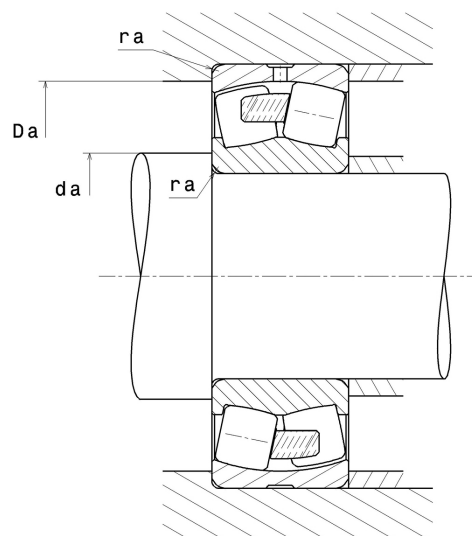

### Abutment dimensions

da min	8.2677 "
Da max	14.9606 "
ra max	0.1575 "

### Calculation factors

#### Equivalent dynamic radial load

$$P = X.F_r + Y.F_a$$

Fa / Fr ≤ e		Fa / Fr > e	
X	Y	X	Y
1	Y1	0.67	Y2

#### Equivalent static radial load

$$P_0 = X_0.F_r + Y_0.F_a$$

X <sub>0</sub>	Y <sub>0</sub>
1	Y0

The values for e, Y1, Y2 and Y0 are shown in the above table .