

## PDF technical sheet 22308EMW33C4



### Double row spherical roller bearings

Spherical roller bearing, one-piece machined cage, groove and lubrication holes on outer ring

Product definition	
d	1.5748 "
D	3.5433 "
B	1.2992 "
d2	2.0669 "
D1	3.0315 "
rs min	0.0591 "
Number of lubrication holes	3
b	0.2323 "
k	0.1181 "
e	0.36
Y1	1.87
Y2	2.79
Y0	1.83
Radial clearance class	C4
Mass	3.60 oz
Brand	SNR

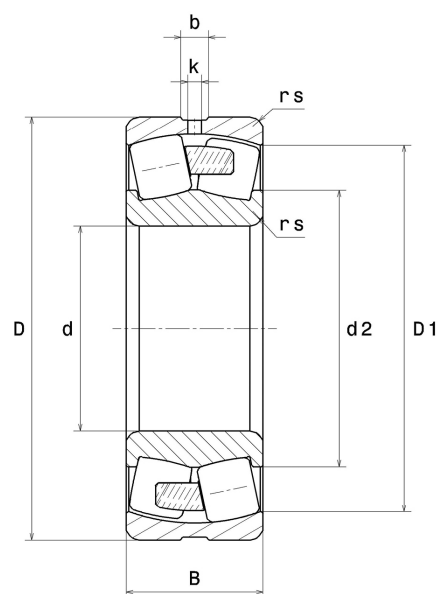

Product performance	
Dynamic load, C	169 kN
Static load, C0	152 kN
Fatigue limit load, Cu	13.70 kN
Nref	5,800 RPM
Nlim	7,400 RPM
Min operating temperature, Tmin	-40 °C
Max operating temperature, Tmax	392 °C
Characteristic cage frequency, FTF	0.41 Hz
Characteristic rolling element frequency, BSF	4.94 Hz
Characteristic outer ring frequency, BPF0	5.67 Hz
Characteristic inner ring frequency, BPF1	8.33 Hz

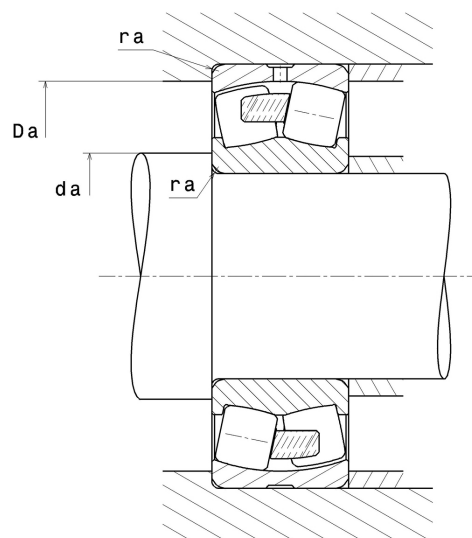

### Abutment dimensions

da min	1.9291 "
Da max	3.1890 "
ra max	0.0591 "

### Calculation factors

#### Equivalent dynamic radial load

$$P = X.F_r + Y.F_a$$

Fa / Fr ≤ e		Fa / Fr > e	
X	Y	X	Y
1	Y1	0.67	Y2

#### Equivalent static radial load

$$P_0 = X_0.F_r + Y_0.F_a$$

X <sub>0</sub>	Y <sub>0</sub>
1	Y0

The values for e, Y1, Y2 and Y0 are shown in the above table .