

PDF technical sheet 22219EA



Double row spherical roller bearings

Spherical roller bearing, pressed steel cage

Product definition

d	3.7402 "
D	6.6929 "
B	1.6929 "
d2	4.3622 "
D1	6.0157 "
rs min	0.0827 "
Number of lubrication holes	
e	0.23
Y1	2.95
Y2	4.4
Y0	2.89
Radial clearance class	CN
Mass	13.93 oz
Brand	SNR

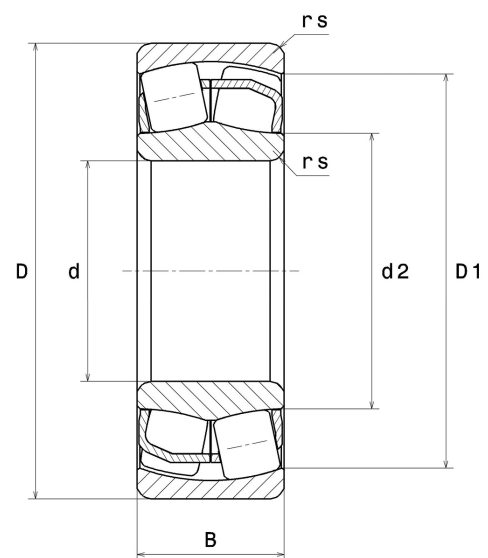

Product performance

Dynamic load, C	416 kN
Static load, C0	417 kN
Fatigue limit load, Cu	47.50 kN
Nref	3,800 RPM
Nlim	4,800 RPM
Min operating temperature, Tmin	-40 °C
Max operating temperature, Tmax	392 °C
Characteristic cage frequency, FTF	0.42 Hz
Characteristic rolling element frequency, BSF	5.95 Hz
Characteristic outer ring frequency, BPF0	7.12 Hz
Characteristic inner ring frequency, BPF1	9.88 Hz

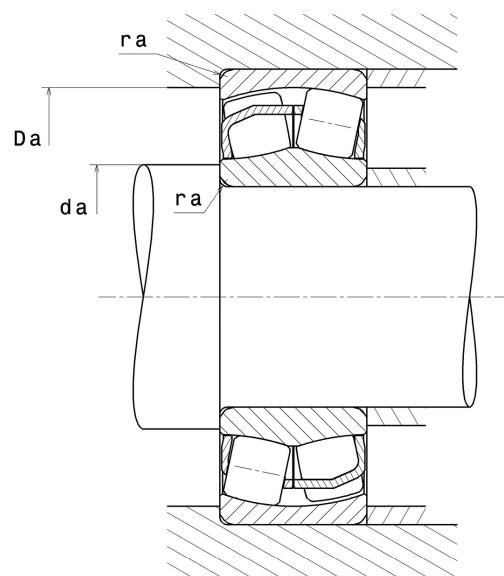

Abutment dimensions

da min	4.2126 "
Da max	6.2205 "
ra max	0.0787 "

Calculation factors

Equivalent dynamic radial load

$$P = X.F_r + Y.F_a$$

Fa / Fr ≤ e		Fa / Fr > e	
X	Y	X	Y
1	Y1	0.67	Y2

Equivalent static radial load

$$P_0 = X_0.F_r + Y_0.F_a$$

X ₀	Y ₀
1	Y0

The values for e, Y1, Y2 and Y0 are shown in the above table .